

Township 81 N. Range 1 E.

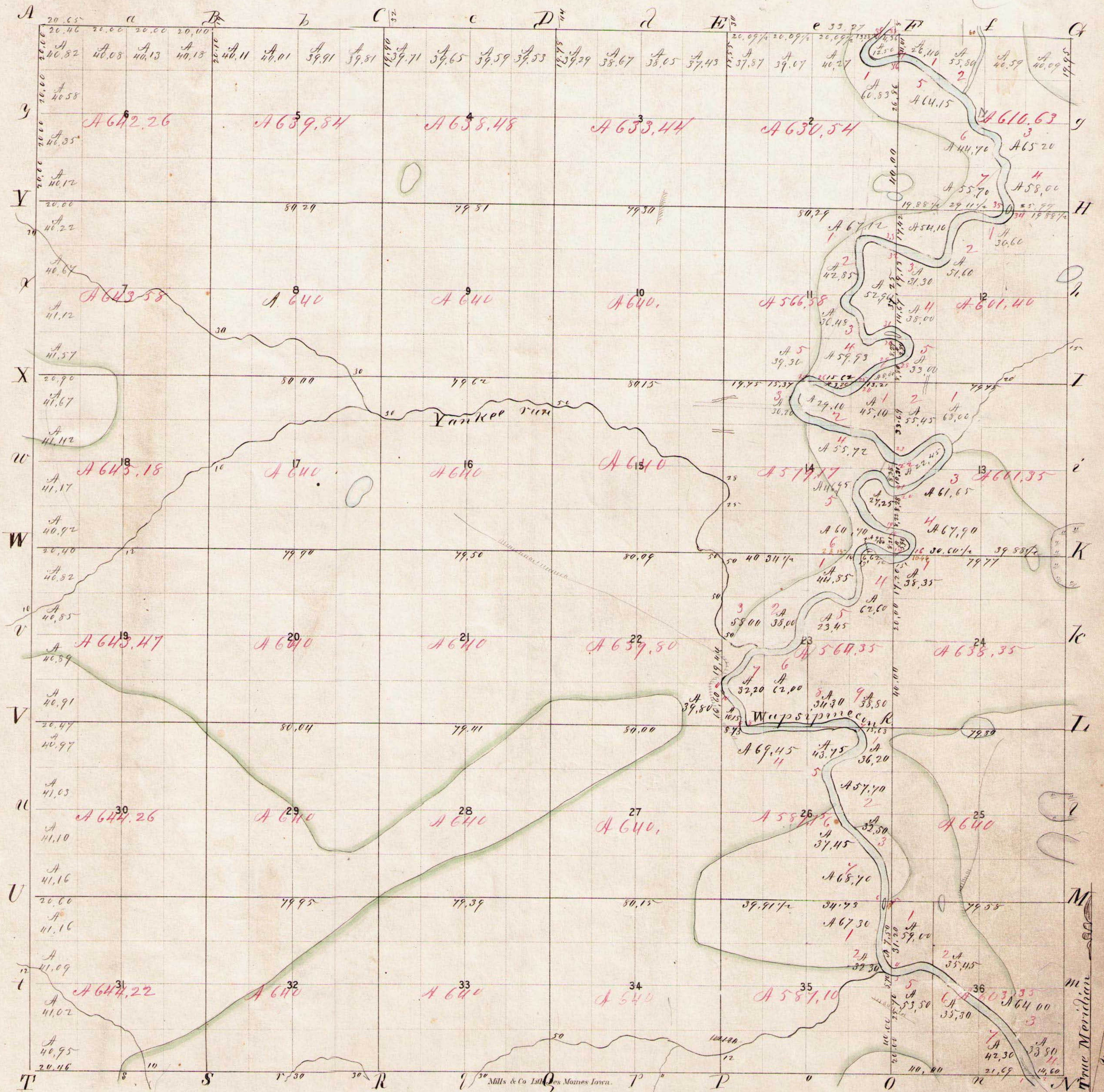

Total number of Acres *22553.08*

Surveys Designated	By whom Surveyed	Date of Contract	Amount of Surveys	When Surveyed	When paid for and chd. in the Sur. Genl's acct.
Township Lines	Wm. A. Burt	Sept. 28, 1836	M. Cts. Lks.	4 th qr 1836	3 ^d qr 1838
Subdivisions	Geo. Clark & Co.	May 28, 1837	83 46 34	4 th qr 1837	3 rd qr 1838

The above Map of Township No. 81 - of Range No. 1 E of the 5th Principal Meridian Iowa Territory is strictly conformable to the field notes of the survey thereof on file in this Office which have been examined and approved.

Surveyor General's Office }
Cincinnati July 1st 1838 }
E. S. Haines
Sur Genl.

Meanders of Wapsipiricon River

Posts	Courses	Chs. Lks.	Posts	Courses	Chs. Lks.	Posts	Courses	Chs. Lks.	Posts	Courses	Chs. Lks.	Posts	Courses	Chs. Lks.
Left bank down stream			1	N 88 1/2 W	3.44		S 28 E	3.46	35	S 6 W	1.68		S 7 W	4.30
35	S 23 1/2 W	2.90	24	S 60 W	3.05		S 45 1/2 E	4.18		S 34 E	3.53	17	S 50 1/2 W	3.25
	S 49 W	4.06		S 46 W	10.62		S 19 E	4.80		S 69 W	2.87		S 84 W	5.60
	S 67 3/4 W	3.81		S 47 1/2 W	4.51		S 11 1/2 E	4.00		N 66 1/2 W	4.75		N 83 1/2 W	3.59
	S 51 W	2.25		S 53 W	9.20		S 4 E	3.80		N 50 1/2 W	7.32		N 42 W	7.60
	S 14 1/2 E	2.55		West	3.81		Cont	4.70		S 81 1/2 W	3.08		S 74 W	7.78
	S 48 1/2 E	3.31		N 82 1/2 W	4.30		N 78 1/2 E	5.56		S 65 1/2 W	2.64	14	S 24 1/2 W	3.60
	S 78 1/2 E	1.22		N 34 1/2 W	3.30		S 88 E	6.70		S 47 W	5.60		S 11 E	11.50
	N 85 1/2 E	1.14		N 50 W	2.90		N 86 E	19.00		S 14 1/2 W	8.45		S 10 W	4.75
	N 70 1/2 E	6.56		N 66 W	2.21		N 73 1/2 E	7.28		S 13 1/2 E	8.35		S 35 W	5.92
	N 80 E	2.04		N 73 1/2 W	2.78		S 85 E	7.00		S 26 W	2.87		N 75 1/2 W	4.10
57	N 68 1/2 E	3.69		S 83 W	2.25		S 33 E	4.96		S 72 1/2 W	2.55		N 56 1/2 W	3.51
	S 89 E	2.74		S 38 W	5.45	7	S 20 1/2 E	6.95		N 78 W	3.78		N 83 1/2 E	4.22
	S 55 E	19.00		S 9 E	5.11		S 24 W	7.15		N 42 1/2 W	3.54		N 81 1/2 W	6.54
	S 66 1/2 E	3.80		S 31 1/2 E	4.30		S 73 1/2 W	6.26		N 64 1/2 W	4.25		S 45 1/2 W	4.50
	S 69 1/2 E	4.30		S 57 1/2 E	5.00		S 58 W	7.31		N 83 W	5.00		S 29 W	6.30
	S 56 1/2 E	3.82		S 74 E	6.50		S 31 1/2 W	3.62	33	N 71 1/2 W	5.10		S 24 W	4.75
	S 58 1/2 E	3.67		S 82 E	22.00		S 22 E	3.81		N 89 1/2 W	14.60		S 2 1/2 W	6.35
	S 11 E	3.03		S 72 1/2 E	1.30		S 7 W	6.09		S 35 E	4.63		S 30 W	3.30
	S 10 W	4.13		S 26 E	4.90		S 34 1/2 E	4.61		S 18 W	7.77		S 62 W	3.05
	S 11 1/2 E	3.82	23	S 41 1/2 E	7.00		S 45 E	3.45		S 12 1/2 E	11.90		S 75 1/2 W	3.52
	S 59 1/2 E	4.57		N 62 1/2 E	3.68		S 34 1/2 E	12.25		S 39 W	6.73		N 87 W	4.35
	N 88 1/2 E	4.00		N 81 E	3.25		S 40 1/2 E	8.48		S 79 W	4.80		N 52 1/2 W	4.50
	S 62 1/2 E	3.56		N 64 1/2 E	3.10		S 66 E	2.15		S 47 1/2 W	1.70		N 67 W	1.55
	S 41 1/2 E	2.50		N 45 E	5.81		S 53 1/2 E	4.28		S 33 W	2.27		S 72 W	4.32
	S 13 1/2 E	1.74		N 58 1/2 E	6.00		S 45 E	4.62		S 15 1/2 E	3.00		S 33 W	6.75
	S 1 1/2 W	3.58		N 86 E	2.30		S 26 1/2 E	5.69		S 57 1/2 E	5.48		S 21 1/2 W	2.92
	S 37 1/2 W	4.04		S 82 1/2 E	3.00		S 4 1/2 E	5.17		S 65 E	3.15		S 37 W	2.30
	S 31 1/2 E	1.64		S 50 1/2 E	3.38		S 8 W	4.00		S 34 1/2 E	4.96		S 62 1/2 W	5.60
	S 49 E	1.15		S 26 E	2.35		S 4 W	4.77		S 20 W	2.07		S 32 1/2 W	2.65
	N 89 E	3.57		S 6 E	3.80	5	S 2 1/2 W	4.60		S 5 E	2.63	11	S 21 W	1.50
	S 44 E	1.79		S 3 1/2 W	3.70		S 7 W	7.58		S 25 E	5.17	10	S 15 E	2.40
	S 15 1/2 E	2.35		S 26 W	5.00		S 1 E	8.00		S 85 1/2 E	2.80		S 15 E	2.70
	S 39 1/2 W	6.45		S 51 1/2 W	20.90		S 12 E	6.90		N 63 1/2 E	9.30		S 53 E	5.40
	S 18 1/2 W	1.82		N 83 W	5.21		S 19 E	2.36		N 83 1/2 E	2.50		S 4 1/2 E	3.80
	S 9 E	3.05	20	N 59 W	3.97		S 45 E	2.31		N 86 1/2 E	1.80		S 2 W	4.35
	S 34 E	2.62		N 18 1/2 W	2.76	4	S 80 1/2 E	2.12	30	S 58 1/2 E	4.17	9	S 3 W	2.00
	S 46 E	2.60		N 2 W	2.70		N 89 E	3.00		S 35 E	2.57		S 54 E	3.73
	S 81 E	3.36		N 81 1/2 W	3.81		N 61 E	2.80		S 27 W	3.07		S 88 E	5.10
31	S 10 1/2 E	3.00		S 79 W	5.40		N 46 1/2 E	2.18	27	S 73 W	3.49		N 83 E	15.46
	S 23 W	4.40		S 39 1/2 W	2.66		S 50 E	4.50		N 88 W	3.43		S 87 E	5.32
	S 41 1/2 W	4.00		S 12 W	6.46		S 74 1/2 E	7.48		S 69 1/2 W	6.87		S 79 E	3.00
	S 67 1/2 W	4.47		S 24 1/2 E	4.10		S 42 1/2 E	5.50		S 42 W	8.50		N 82 1/2 E	6.90
	N 69 1/2 W	5.19		S 37 1/2 E	1.50		S 59 1/2 E	21.51		S 35 1/2 W	1.57		N 66 E	6.20
	N 62 1/2 W	2.78		S 53 E	1.50		S 51 E	15.00	25	S 31 W	2.17		S 31 1/2 E	4.87
	N 85 1/2 W	5.05		S 31 1/2 E	8.50		S 41 E	9.74		N 56 W	6.35		S 65 1/2 E	5.65
	S 60 W	3.50		S 53 E	1.63		S 28 1/2 E	5.05	26	N 54 1/2 W	5.60		S 30 1/2 E	1.26
	S 50 W	3.00		S 77 E	5.00		S 10 E	12.50		N 32 1/2 W	3.75		S 4 E	3.29
	S 10 W	5.18		S 83 1/2 E	1.05					N 47 W	4.60		S 41 1/2 W	6.25
	S 12 E	4.95	19	S 79 1/2 E	0.98					N 82 1/2 W	8.78		N 85 1/2 W	4.19
	S 6 1/2 W	3.10		N 80 E	4.00	39	S 44 1/2 W	4.40	27	S 43 1/2 W	5.50		S 50 W	3.90
	S 16 1/2 W	2.68		S 74 E	3.50		S 64 1/2 W	4.00		S 19 1/2 W	7.84		S 55 1/2 W	5.60
	S 21 1/2 W	4.12		S 55 E	3.94		S 43 1/2 W	2.60		S 9 E	6.30		S 23 W	5.25
	N 86 1/2 W	4.70		S 13 E	3.50		S 28 W	3.80		S 43 E	7.57		S 18 1/2 W	7.20
	N 86 1/2 W	4.70		S 14 W	3.86		S 35 1/2 E	5.40		S 64 1/2 E	6.50		S 43 1/2 E	4.00
	N 73 W	6.26		S 33 1/2 W	2.22		S 48 E	1.80		S 79 E	26.20		S 29 E	2.50
	N 50 W	3.40	16	S 54 1/2 W	3.50		S 75 1/2 E	1.81		S 39 1/2 E	15.15		S 8 E	6.50
	N 71 1/2 W	4.00		S 84 W	6.46		S 89 E	4.25	22	S 86 1/2 E	1.05		S 24 E	4.00
	N 83 1/2 W	6.04		N 85 1/2 W	4.00		N 80 1/2 E	4.70		N 68 1/2 E	3.85		S 63 E	15.80
32	N 54 1/2 W	2.30		N 62 1/2 W	2.00	36	N 55 1/2 E	3.60		N 82 E	3.80		S 47 1/2 E	5.00
	N 68 W	6.18		N 46 W	1.62		S 89 E	6.82		N 59 1/2 E	4.00		S 52 1/2 E	4.00
	N 58 W	5.38		N 63 W	0.70		S 51 1/2 E	14.81		N 39 E	3.00		S 17 1/2 E	9.10
	N 76 1/2 W	2.10	12	N 35 W	2.90		S 63 1/2 E	2.10		N 35 1/2 E	3.00		S 17 1/2 E	4.80
	S 15 W	4.80		S 70 1/2 W	3.50		S 71 1/2 E	6.64		N 45 E	3.00		S 13 W	5.00
	S 12 1/2 E	11.68		S 57 1/2 W	0.95		S 60 1/2 E	6.28		N 61 1/2 E	2.50		S 9 E	3.00
	S 8 1/2 W	2.80	13	S 50 W	1.00		S 18 1/2 E	2.00		S 71 E	3.00		S 4 W	8.50
	S 25 W	2.79		S 12 E	5.60		S 3 1/2 W	9.00		S 37 E	2.00		S 15 1/2 W	5.50
	S 39 W	3.60		S 18 E	4.00		S 26 E	2.50		S 2 W	2.11		S 7 W	7.74
	S 72 1/2 W	3.47		S 5 1/2 E	3.90		S 56 E	3.17		S 26 1/2 W	3.50		S 23 1/2 E	12.50
	S 64 W	2.05		S 10 1/2 W	4.81		S 74 1/2 E	2.47		S 41 1/2 W	3.50	3	S 66 E	2.50
	S 18 1/2 W	1.47		S 27 W	7.18		N 89 E	5.40		S 56 W	4.10		S 74 1/2 E	4.00
	S 19 1/2 E	1.20		S 65 1/2 W	5.10		S 46 1/2 E	1.88		S 48 W	4.00		N 78 1/2 E	4.50
	S 60 E	3.28		N 86 1/2 W	4.54		S 20 E	3.00		S 60 W	6.94		N 50 1/2 E	4.85
	S 32 1/2 E	5.41		N 66 W	4.65		S 20 W	3.30		S 79 W	6.00		S 79 1/2 E	5.50
	S 30 E	3.81		N 79 1/2 W	4.20		S 37 1/2 W	2.95		S 45 1/2 W	1.20		S 48 E	8.50
	S 2 1/2 W	2.49		S 81 W	2.55		S 9 E	2.80	21	N 66 W	2.00		S 55 1/2 E	14.65
	S 8 E	3.10		S 43 W	2.18		S 65 E	3.78		N 11 W	5.70		S 40 1/2 E	3.50
	S 59 E	1.31		S 19 W	11.30		N 85 E	1.70		N 75 W	6.50		S 61 E	5.00
	S 62 1/2 E	7.04		S 5 1/2 W	3.95		S 62 E	1.06		S 79 W	6.00		S 49 1/2 E	12.63
	N 73 E	3.50		S 26 W	4.75		S 1 W	1.43		S 47 W	4.90		S 33 1/2 E	14.00
	N 80 1/2 E	2.60		S 61 W	16.10		S 28 W	1.86		S 93 1/2 W	8.03		S 12 1/2 E	5.13
31	S 58 1/2 E	5.51		N 85 W	6.00	36	S 44 1/2 W	4.00		S 27 1/2 E	7.60	1	S 10 1/2 E	2.34
	S 43 1/2 E	4.29		N 58 W	3.95		S 10 1/2 W	4.34		S 35 E	9.58			
	S 3 1/2 E	3.70		N 82 W	2.15		S 23 E	3.85		S 50 E	3.61			
	S 27 1/2 W	3.94		S 25 1/2 W	8.48		S 47 1/2 E	1.95	15	S 78 E	7.59			
	S 61 W	4.77		S 62 W	4.43		S 10 E	2.39						