

Township 82 N. Range 3 E

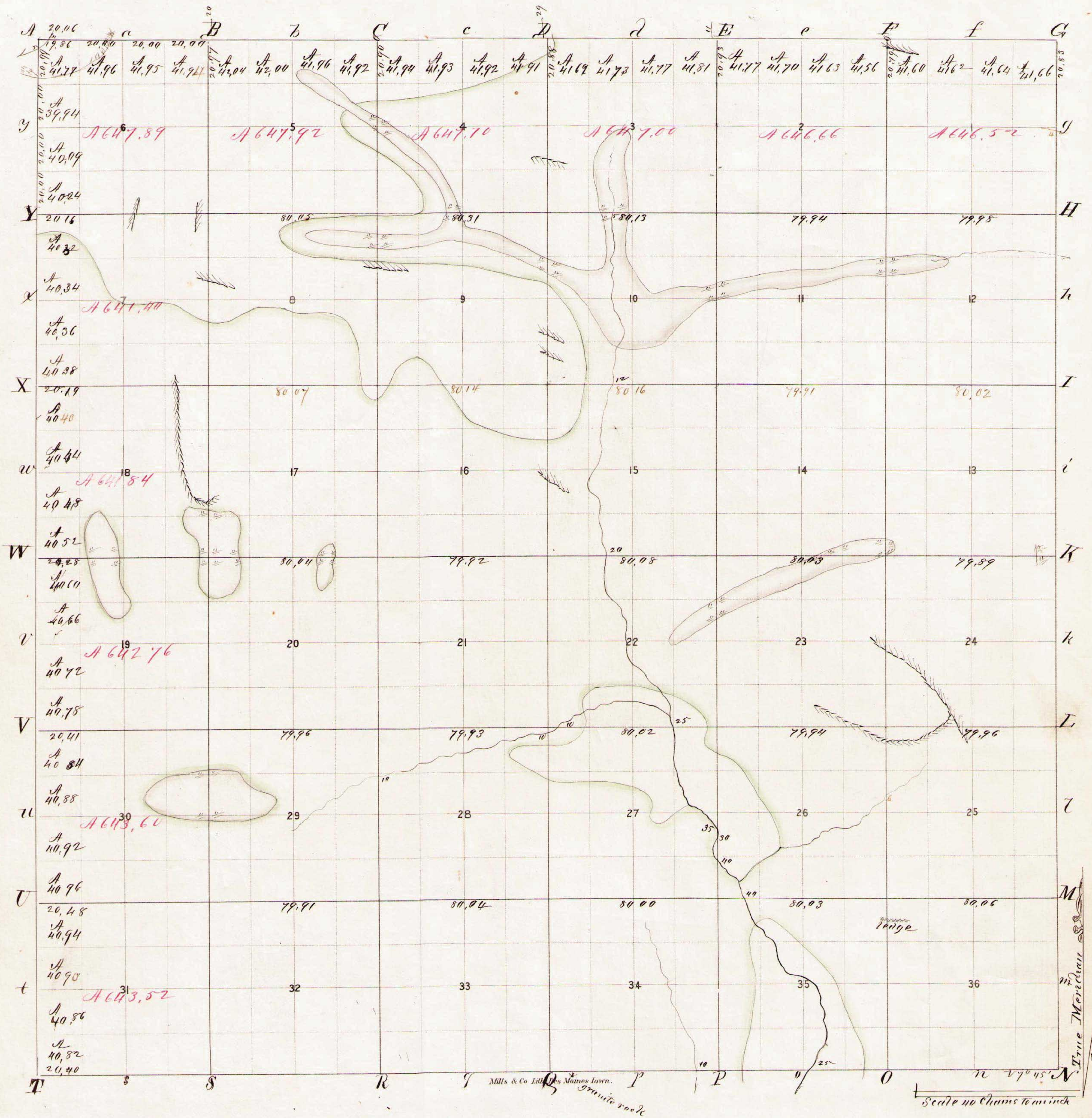

Total number of Acres **23,096.81**

Surveys Designated	By whom Surveyed	Date of Contract	Amount of Surveys	When Surveyed	When pd for and chd. in the Sur. Sect. acct.
Township lines	Wm A. Burt	Sept. 25, 1836	24 02 28	1 st gr. 1837	3 rd gr. 1838
Subdivisions	John W. Barry	June 3, 1837	60 05 99	3 rd gr. 1837	3 rd gr. 1838

The above Map of Township No. 82 North of Range No. 3 East of the 5th Principal Meridian Wisconsin Territory is strictly conformable to the field notes of the survey thereof on file in this Office, which have been examined and approved,

E. S. Haines
The Genl.