

Township 82 N. Range 4 E.

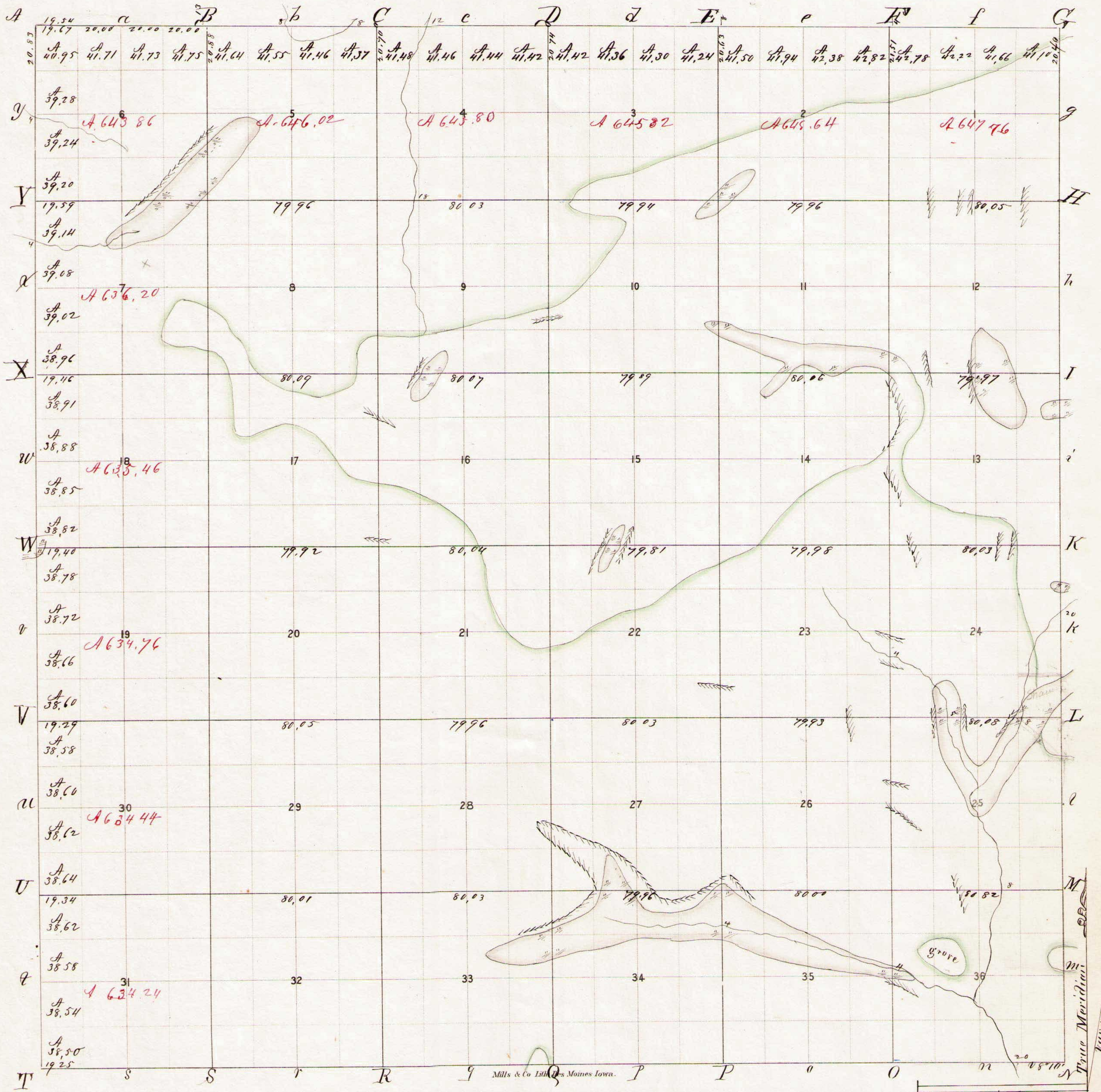

Total number of Acres 23,052.50

Surveys Designated	By Whom Surveyed	Date of Contract	Amount of Surveys	When Surveyed	When paid for and Chg. in the Sur. Gen's acct.
Township Lines	Wm. A. Burt	Sept. 28, 1836	M. Chs. Lks.	1 st qr. 1837	3 ^d qr. 1838
Subdivisions	John Wherry	June 3, 1837	60 00 54	3 rd qr. 1837	3 ^d qr. 1838

The above Map of Township No. 82 North of Range No. 4 East of the 5th Principal Meridian Wisconsin Territory is strictly conformable to the field notes of the survey thereof on file in this Office, which have been examined and approved.

Surveyor General's Office }
 Cincinnati July 1. 1838. } E. S. Ruess
 Sur. Gen'l.