

# Township 83 N. Range 1 E.

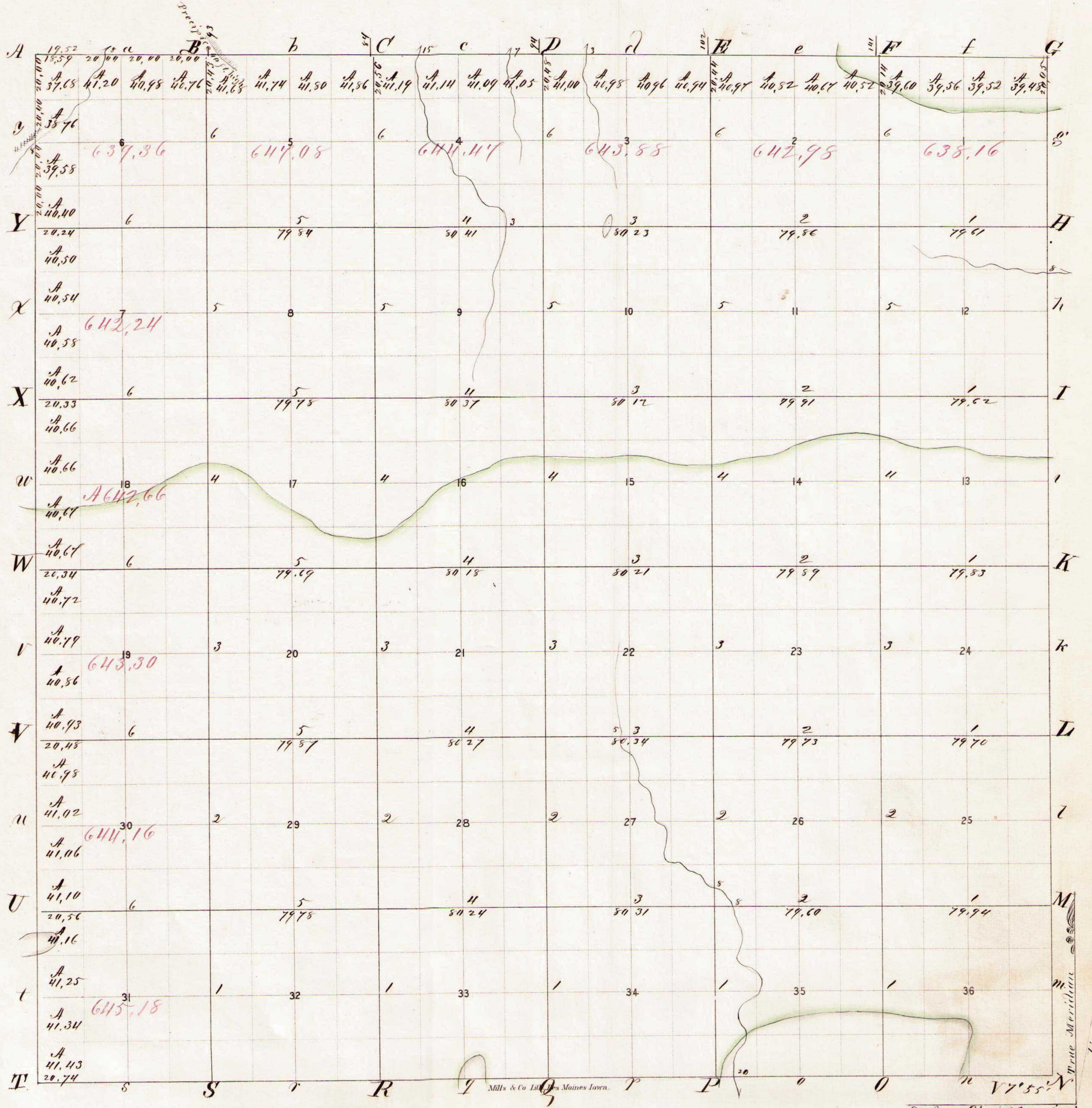

Total number of Acres *23,073.47*

Surveys Designated	By whom Surveyed	Date of Contract	Amount of Surveys	When Surveyed	When performed and Chd in the Sur. Genl's acct.
Township lines	William A. Burt	28 <sup>th</sup> Sept. 1836	24 " 00 " 31	1 <sup>st</sup> gr 1837 3 <sup>rd</sup> gr 1838	
Subdivisions	Willard Barrows	21 <sup>st</sup> Nov. 1837	60 " 04 " 00	1 <sup>st</sup> gr 1838 2 <sup>nd</sup> gr 1838	

The above Map of Township No. 83 of Range No. 1 E of the 5<sup>th</sup> Principal Meridian Iowa Territory is strictly conformable to the field notes of the survey thereof on file in this Office which have been examined and approved.  
 Surveyor General's Office  
 Cincinnati July 1. 1838.  
 E. S. Haines  
 Sur<sup>r</sup> Genl.

State Land Office  
 Des Moines Iowa April 22. 1848

I David Secor Register of the State Land Office of the State of Iowa hereby certify that the above is a true copy of the original plat in this Office.  
 In testimony whereof I have hereunto set my hand and affixed my official seal this 22<sup>nd</sup> day of April A.D. 1848.  
 David Secor Register.

