

# Township 83 N. Range 2 E.

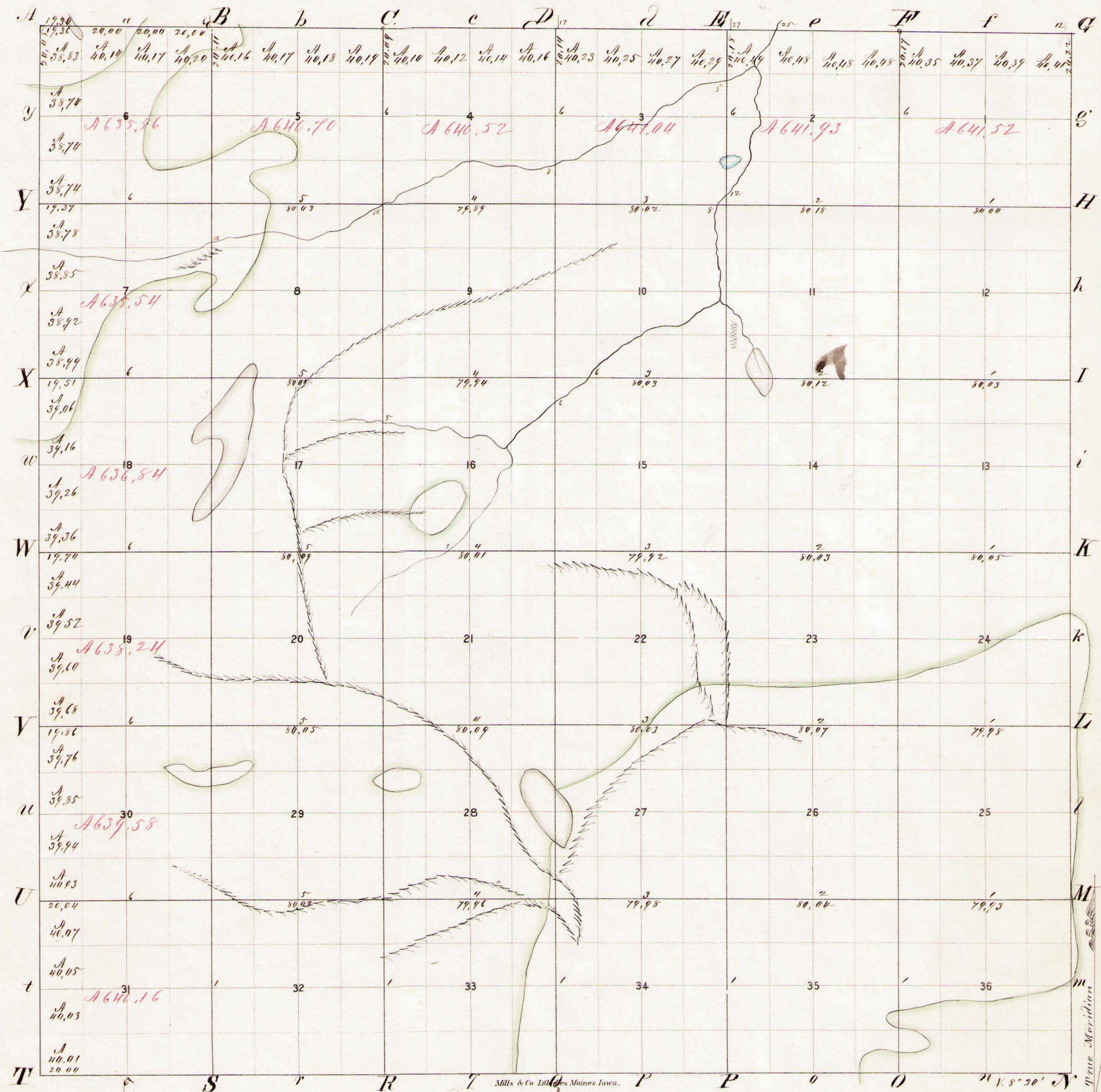

Total number of Acres 23031.63

Scale 40 Chains to an inch

Surveys Designated	By whom Surveyed	Date a Contract	Amount of Surveys	When Surveyed	When 1/2 <sup>d</sup> Sec and Ch <sup>s</sup> in the Sur Gen <sup>l</sup> 's acct.
Township lines	Wm. A. Burt	Sept. 28, 1836	M. Chs. Lks. 23 79 54	1 <sup>st</sup> qr. 1836	3 <sup>rd</sup> qr. 1838
Subdivisions	John Wherry	June 3, 1837	59 79 17	3 <sup>rd</sup> qr. 1837	3 <sup>rd</sup> qr. 1838

The above Map of Township No. 83 North of Range No. 2 E. of the 5<sup>th</sup> Principal Meridian Wisconsin Territory is strictly conformable to the field notes of the survey thereof on file in this Office, which have been examined and approved (Surveyor General's Office) Cincinnati July 1, 1838. E. S. Haines Sur. Genl.

State Land Office  
Des Moines Iowa

I, David Secor Register of the State Land Office of the State of Iowa hereby certify that the above is a true and correct copy of the original plat of Government survey in this Office.  
In testimony whereof I have hereunto set my hand and affixed my official Seal, this 22nd day of April A.D. 1848.  
David Secor, Register.