

# Township 83 N. Range 6 E.

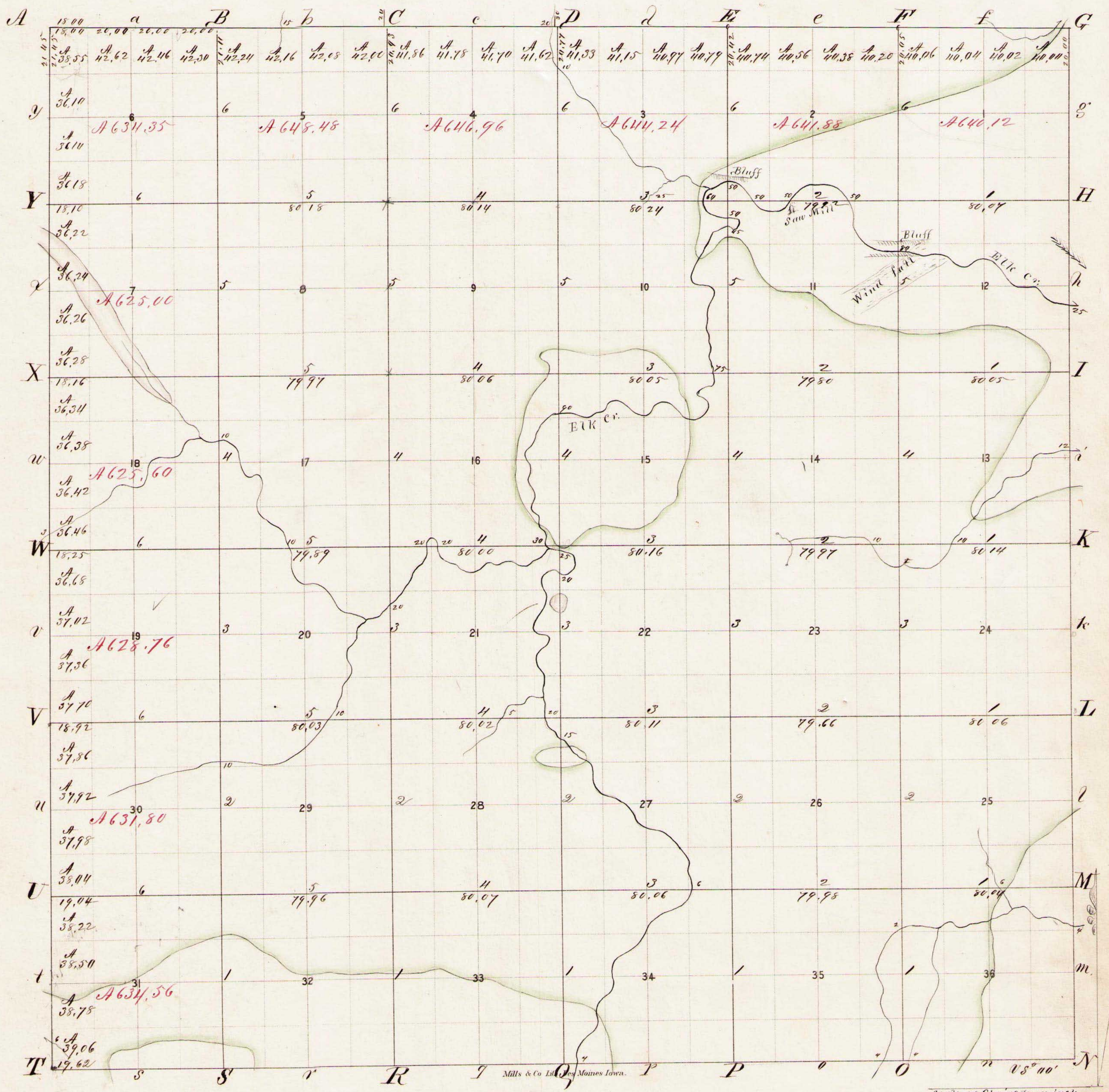

Total number of Acres **23,001.75**

Surveys Designated	By whom Surveyed	Date of Contract	Amount of Surveys	When Surveyed	When paid for and charged to the Sur. Gen's acct.
Township lines	Wm. A. Burt	Sept 28, 1836	M. Chs. Lts 23,79.04	1 <sup>st</sup> gr 1837	3 <sup>rd</sup> gr 1838
Subdivisions	John Wharry	June 3, 1837	59,75.75	3 <sup>rd</sup> gr 1837	3 <sup>rd</sup> gr 1838

The above Map of Township No. 83 North of Range No. 6 E. of the 5<sup>th</sup> Principal Meridian Wisconsin Ter. is strictly conformable to the field notes of the survey thereof on file in this Office which have been examined and approved.  
 Surveyor General's Office }  
 Cincinnati July 1, 1838 } C. S. Haines  
 Sur. Genl.



I, David Seear Register of the State Land Office of the State of Iowa, hereby certify that the foregoing is a true and correct copy of the original plat of Government Survey in this Office.  
 In testimony whereof I have hereunto set my hand and affixed my official Seal, this 22<sup>nd</sup> day of April A.D. 1878.  
 David Seear Register

State Land Office  
 Des Moines Iowa

Lyons  
Olin  
1312.81 ac  
4918.79 "  
6231.60 "  
9.757 89 ml

165  
295

3078  
12312